

# Insertion Pad System

We propose one 2-pin type TPA-02 and two 1-pin type TPA-08 and TPA-09.



TPA-02



TPA-08



TPA-09



INTER EYES CO.,LTD.

**EV** EURO VISION CO.,LTD.



## [2-pin type]

**TPA-02 Material: Titanium** Only M1.2 is available in all types.

TPA-02S

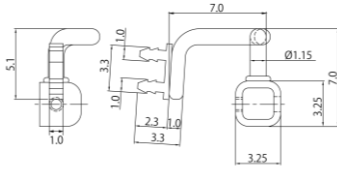

TPA-02M

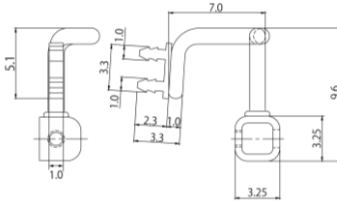

TPA-02L

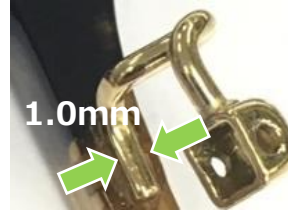
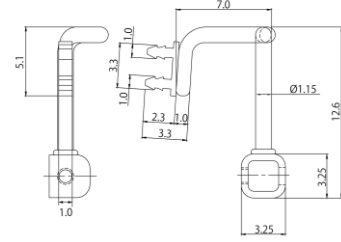

The front of the frame can be designed to be thin because the width is "just 1.0mm thin" as shown in the picture below.

**Color Variations** PVD colors are available.

Raw  
(material color)



Gold  
(PVD)



Black  
(PVD)



## [1-pin type]

**Material: Beta titanium Inserting part: Stainless steel**



The cost is reduced by using stainless steel for the inserting part.

TPA-08

M1.0 and M1.2 are available in both types.

TPA-08S

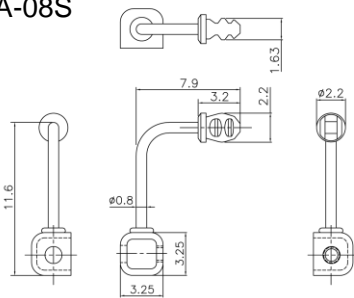

TPA-08M

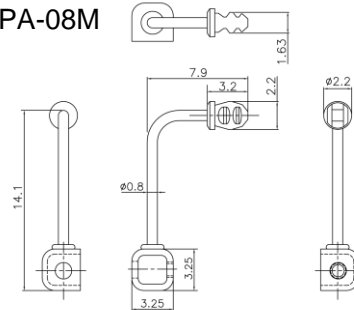

**Color Variations**



Raw  
(material color)



Gold(PVD)



Black(PVD)

**TPA-09(Gooseneck-Shape)**

Only M1.2 is available in both types.

TPA-09S

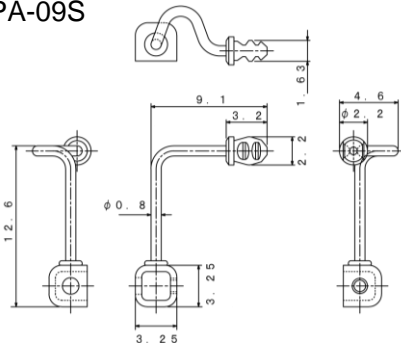

TPA-09M

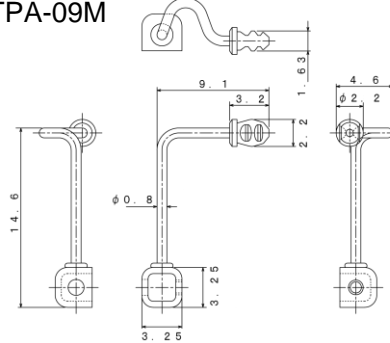

**Color Variations**



Raw  
(material color)



Gold(PVD)



Black(PVD)